

VELUX Skylight installed in new metal roofing.

1. The sheets are fitted 100 mm from the bottom frame
2. The flashing is mounted
3. Fit the metal sheets

BASIS OF DESIGN:
VELUX Venting
Skylight (VS, VSE)

	VS VSE
	EDW
	PROFLED METAL SHEETS
	15°-90°

VELUX Skylight installed in to existing metal roofing. **ELEVATIONS**

1. The metal sheet is cut to allow for the flashing apron.
The cut must stop on top of a profile
(min 270 mm from the side frame)
2. The filler piece is placed so it fits the cut
(can be fixed to the existing metal sheets with rivets)
(Shape the filler piece from the cut-out sheets of
the skylight)

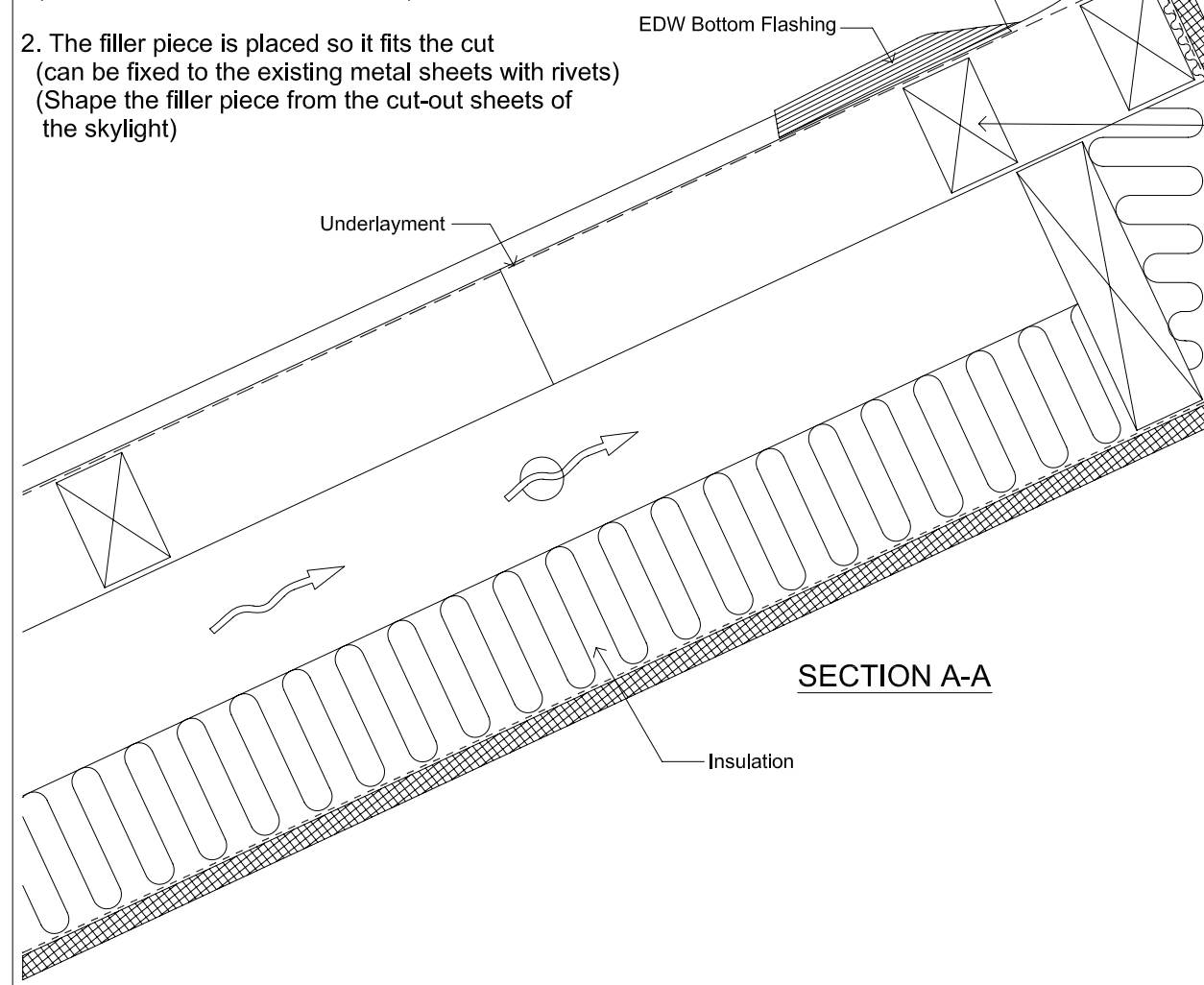

SECTION A-A

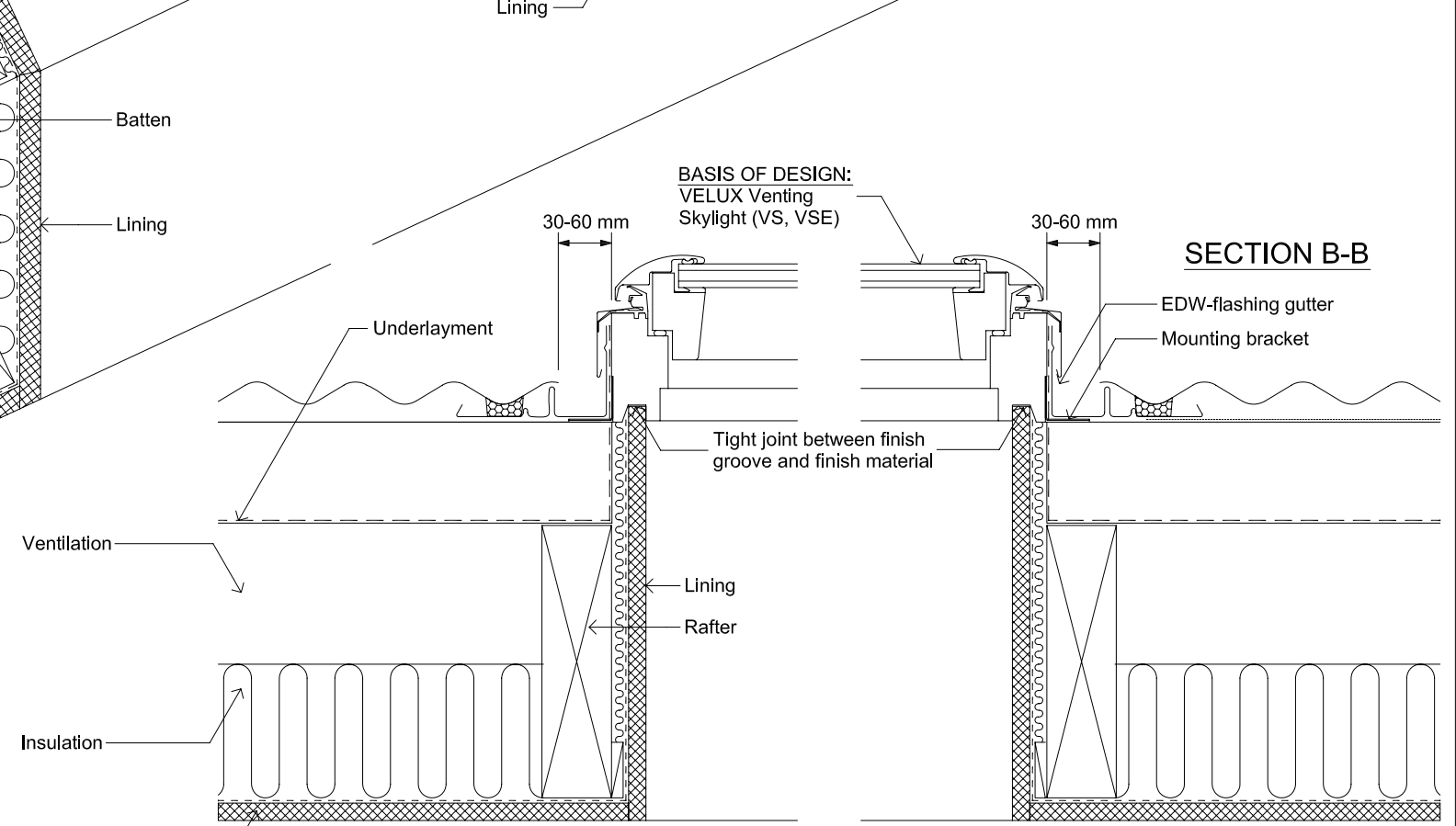

SECTION B-B

	AUSTRALIA PTY. LTD		Name	Date
	+612 8565 6000		Drawn by	Dec. 09
	Sky-Product Management		Checked by	Dec. 09
	VS, VSE - Venting Skylight and EDW Flashing in Profiled Metal Roof		Drawing No.	

This drawing is an instrument of service and is provided for informational use only.